

Dublin Bike Shelter



Specification

- Bolt down.
- **Irish** manufactured.
- 10 bike capacity.
- ideal for schools, office blocks & commercial environments.
- [See more online.](#)



Design & Material

- Galvanised so rust free.
- Shelter comes with steel frame & shatter resistant polycarbonate sheets for back & sides.
- Designed to be used as smoking shelter also.

Components & Installation

- [Cycle stands](#) (not Included).
- Comes with a kit for quick self-install.
- Note that shelter bases should be bolted into pre-existing concrete pads for best results.
- Pittman also provide [bike shelter installation.](#)



CAD Drawing

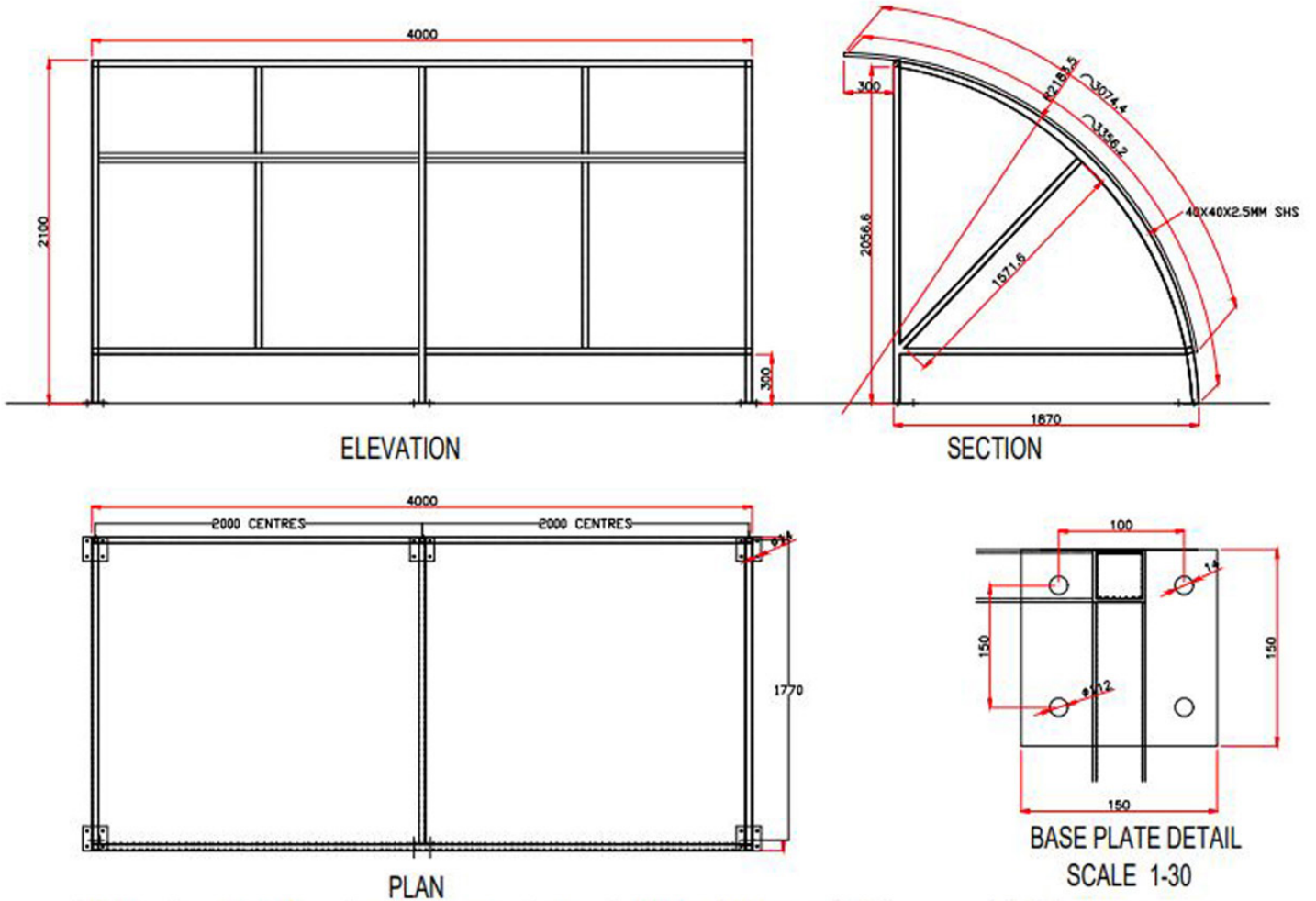

Dimensions

Shelter	Dimensions	Base Plate	Dimensions
Height	2100mm	Length	150mm
Length	4000mm	Width	150mm
Width	1870mm		