

TECHNICAL CHARACTERISTICS

- > Thickness: 75 mm
- > Display: single or double-sided
- > Display size: 9 to 30 A4 (double-sided)
- > Plexichocs® glazing or 4 mm thick safety glass
- > Opening system: reversible side opening or dual door or raising door with gas struts
- > Closure: safety lock with 2 keys. 2 locks on 1350 mm high side opening doors and on raising doors
- > Waterproof: elastomer seal
- > Aluminium frame, high-precision rounded corners
- > Procity® magnets: included (1 per A4, limited to 20 per notice board)



Code 510074

INSTALLATION

- > Wall-mounted (Fittings not supplied) or post-mounted

OPTIONS

- > Round Ø 76 mm or Quatro posts
- > Headers
- > LED lighting kit



Code 410070



PRODUCT CODES & DIMENSIONS

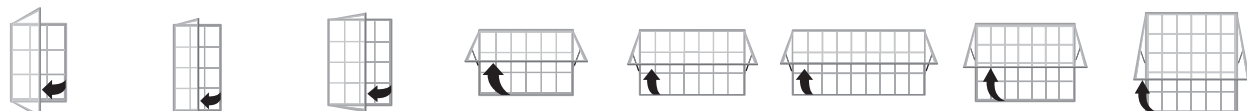

	9 A4	12 A4	16 A4	18 A4	21 A4	27 A4	28 A4	30 A4
Outside dimensions	H 1000 x W 750 mm	H 1350 x W 750 mm	H 1350 x W 1000 mm	H 1000 x W 1350 mm	H 1000 x W 1600 mm	H 1000 x W 2010 mm	H 1350 x W 1710 mm	H 1710 x W 1350 mm
Visible display surface	H 901 x W 651 mm	H 1251 x W 651 mm	H 1251 x W 901 mm	H 889 x W 1239 mm	H 889 x W 1489 mm	H 889 x W 1899 mm	H 1239 x W 1599 mm	H 1599 x W 1239 mm
Door type	Side opening	Side opening	Side opening	Raising	Raising	Raising	Raising	Raising
Plexichoc® glazing - Single-sided / double-sided								
Anodised	510070 / 512070	510002 / 512002	510003 / 512003	510071 / 512071	510072 / 512072	510075 / 512075	510073 / 512073	510074 / 512074
Painted	410070 / 412070	410002 / 412002	410003 / 412003	410071 / 412071	410072 / 412072	410075 / 412075	410073 / 412073	410074 / 412074
Safety glass - Single-sided / double-sided								
Anodised	510420 / 511420	510352 / 512352	510353 / 512353	510421 / 511421	510422 / 511422	510425 / 511425	510423 / 511423	510424 / 511424
Painted	410420 / 411420	410352 / 412352	410353 / 412353	410421 / 411421	410422 / 411422	410425 / 411425	410423 / 411423	410424 / 411424
Optional LED kit - Single-sided*	509116	509123	509102	509136	509106	509109	509107	509104

FINISH PAINTED

- > Interior finish: white lacquered galvanised sheet metal backplate, back painted light grey
- > Frame finish: silver anodised aluminium or painted to match our range of notice board colours



Code 412073 + 416411

OUTDOOR DISPLAY

QUATRO POSTS for "1000" and "2000" notice boards

TECHNICAL CHARACTERISTICS

Quatro posts

- > 2 oblong posts with a 80 x 125 mm cross-section, in silver anodised or painted aluminium
- > Screwed caps in black sheet steel
- > Secured by 4 moulded aluminium connectors (supplied)
- > Adjustable notice board height

Additional Quatro post

- > To connect several "1000" or "2000" notice boards on posts
- > 1 oblong post supplied with 4 connectors

INSTALLATION

- > Installation by concreting directly into the ground or on baseplates (mounting brackets supplied)
- > Additional Quatro post: if exposed to strong winds, concreting directly into the ground is strongly recommended

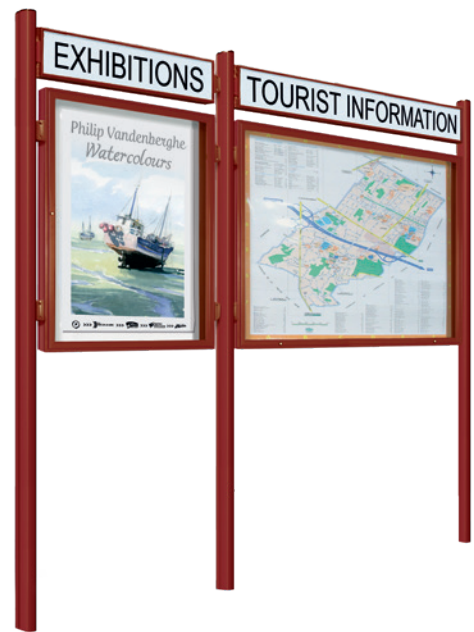

Code 407081 + 407080 + 416404 + 416406 + 402912 + 402910

PRODUCT CODES

	For notice boards up to 1050 mm high			For notice boards greater than the height of 1350 mm		
	Post height	Anodised	Painted	Post height	Anodised	Painted
Posts without header						
Kit containing 2 original posts on baseplates	2058 mm	516401	416401	2208 mm	516405	416405
Additional post on baseplate	2058 mm	516403	416403	2208 mm	516407	416407
Kit containing 2 original posts to be concreted directly into the ground	2475 mm	516400	416400	2700 mm	516404	416404
Additional post concreted directly into the ground	2475 mm	516402	416402	2700 mm	516406	416406
Posts with header						
Kit containing 2 original posts to be concreted directly into the ground	2700 mm	516404	416404	3000 mm	516408	416408
Additional post concreted directly into the ground	2700 mm	516406	416406	3000 mm	516409	416409

FINISH PAINTED

- > Posts in silver anodised aluminium or painted to match our range of notice board colours

Anodised / RAL 9006	RAL 3004	RAL 5010	RAL 6005
RAL 8017	RAL 9005	PRO-CITY® Grey	

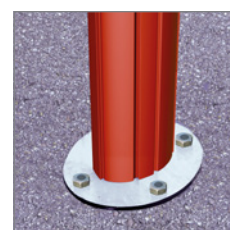

OUTDOOR DISPLAY

ROUND Ø 76 MM POSTS for "1000" and "2000" notice boards

TECHNICAL CHARACTERISTICS

- > 2 round posts, Ø 76 mm, in silver anodised or painted aluminium
- > Screw-fastened caps in black sheet steel
- > Quick, no-drill fastening with 4 moulded aluminium connectors (supplied)
- > Adjustable notice board height



Code 414021 + 402917 + 416411*

INSTALLATION

- > Installation by concreting directly into the ground

PRODUCT CODES

	For notice boards up to 1050 mm high			For notice boards from a height of 1350 mm		
	Post height	Anodised	Painted	Post height	Anodised	Painted
Posts without header						
Kit containing 2 original posts to be concreted directly into the ground	2475 mm	516410	416410	2700 mm	516411	416411
Posts with header						
Kit containing 2 original posts to be concreted directly into the ground	2700 mm	516411	416411	3000 mm	516413	416413



Code 507080 + 516410

FINISH PAINTED

- > Posts in silver anodised aluminium or painted to match our range of notice board colours

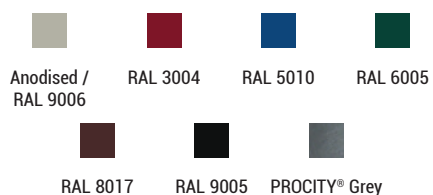

OUTDOOR DISPLAY

HEADER for "1000" and "2000" notice boards

TECHNICAL CHARACTERISTICS

- > 75 mm thick aluminium frame:
 - right-angled corners for "1000" notice boards
 - rounded corners for "2000" notice boards
- > Total height: 220 mm
- > Display height: 190 mm
- > Surface in white lacquered galvanised sheet metal
- > Supplied Blank: Ready for printing

INSTALLATION

- > Supplied with 4 fixings and screws

PRODUCT CODES & DIMENSIONS

Notice board width	Anodised	Painted
Header for "1000" notice boards		
750 mm	502910	402910
1000 mm	502911	402911
1200 mm	502918	402918
1350 mm	502912	402912
1600 mm	502913	402913
1800 mm	502917	402917
2010 mm	502914	402914
2250 mm	502919	402919
Header for "2000" notice boards		
750 mm	502900	402900
1000 mm	502901	402901
1350 mm	502902	402902
1600 mm	502903	402903
1710 mm	502906	402906
2010 mm	502904	402904

FINISH PAINTED

- > Frame in silver anodised aluminium or painted to match our range of notice board colours



Header for "1000" notice boards*



Header for "2000" notice boards*

DRAWING

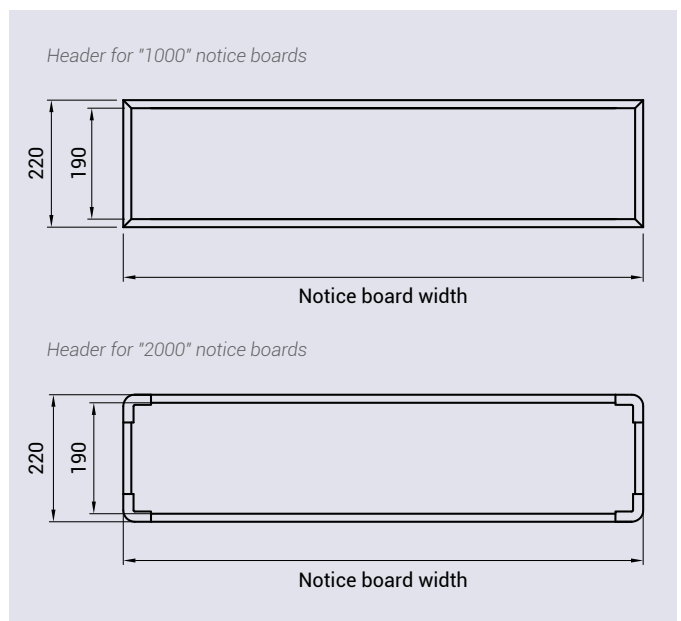

TECHNICAL CHARACTERISTICS

- > High-quality white light, 120 lumens per watt, LED: IP 20, 4000 kelvin
- > IP 67 transformers
- > Run time: 75,000 operating hours
- > Power consumption: 12.5 watts per linear metre
- > Reference table: see the product code for the applicable sized notice board
- > Wiring recommendations (maximum distance per linear metre of LED ribbon):
 - 5 m with 2 x 0.75 mm cable
 - 10 m with 2 x 1.5 mm cable
 - 15 m with 2 x 2.5 mm cable
- > Kits consisting of one or more adhesive LED ribbons and a transformer, depending on the size of the notice board
- > Please note that LED kits are not suitable for display lighting

INSTALLATION

- > Installation required: Not Factory fitted.
- > Warning: the electrical connection must be carried out by a professional Electrician and comply with current applicable safety regulations



Code 407084 + 509117



Code 406080 + 509117

PRODUCT CODES & DIMENSIONS

	LED ribbon length	Number of LED ribbons
Transformer power - 18 W		
509100	450 mm	1
509101	650 mm	1
509103	1150 mm	1
509115	500 mm	1
509116	700 mm	1
509117	900 mm	1
509120	1100 mm	1
509121	1300 mm	1
509130	950 mm	1
509135	800 mm	1
509136	1250 mm	1
Transformer power - 36 W		
509123	700 mm	2
509102	950 mm	2
509106	1550 mm	1
509108	1750 mm	1
509109	1950 mm	1
509131	1350 mm	1
Transformer power - 60 W		
509104	1300 mm	2
509107	1650 mm	2
509110	2250 mm	1
509124	700 mm	4
509132	950 mm	4
509133	1550 mm	2
509138	1950 mm	2
Transformer power - 100 W		
509134	1650 mm	4
509137	1300 mm	4